

almonTE SQUARE

At the centre of growth

Site plan & key features

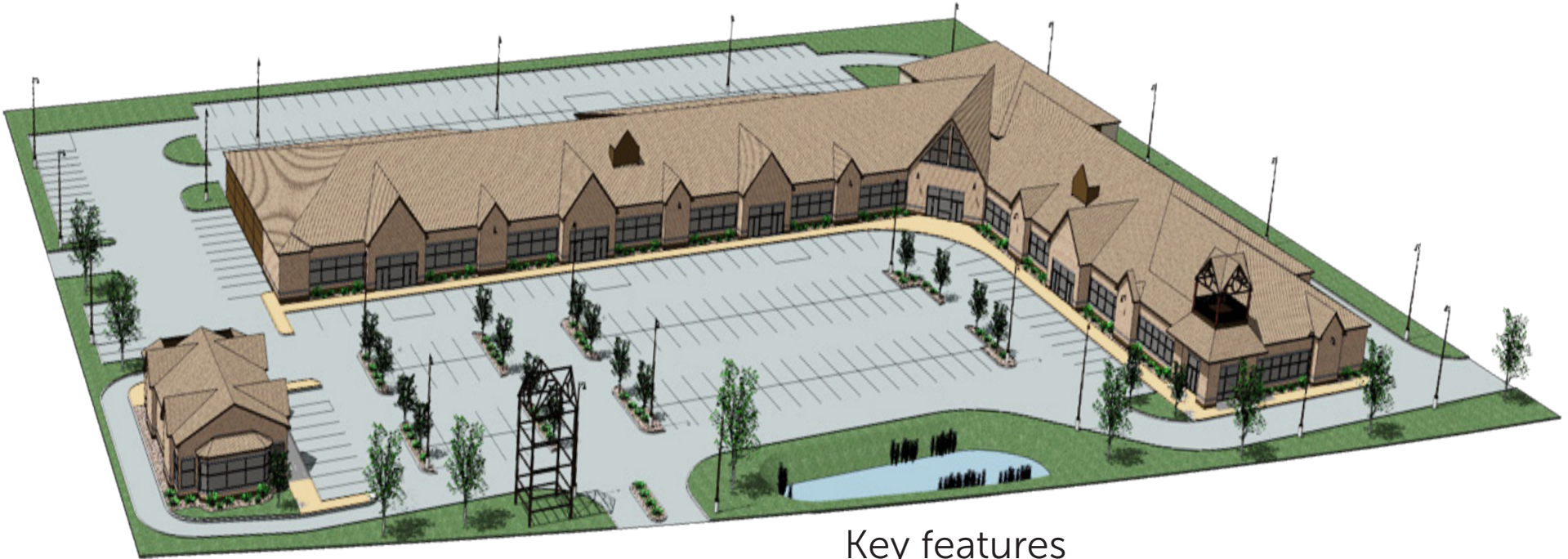

Property managed by



For leasing information:
info@almontesquare.com
Telephone: (905)709-8232

Key features

- Total leasable area: 57,200 sq.ft.
- Total gross area: 64,375 sq. ft.
- Surface parking: 281
- Freestanding pad with drive-through
- CAM: \$4.08 per sq. ft.
- Taxes: \$2.40 per sq. ft.
- Traffic: 15,000 vehicles per day
- Professional property management by Elm Developments
- Located at 430 Ottawa St. (Highway 44), a four lane arterial road to Highway 417 to Ottawa
- At the centre of growth

*This information is for discussion and marketing purposes only.
Rendering is artist's concept. E.&O.E.*